

UNDERSTANDING THE ENVIRONMENTAL STATEMENT

November 2013

The Environmental Statement (ES) is an assessment of the likely significant environmental effects of the proposed HS2 railway between London and the West Midlands. Prepared by independent consultants, it reports on the effects of constructing and operating Phase One of HS2 from an environmental point of view.

What is the ES for?

The Government is promoting legislation for Phase One of High Speed Two – a new, north-south railway to run between London, Birmingham and the West Midlands. On 25th November 2013, a Bill was deposited in Parliament with a view to providing the powers to construct, operate and maintain the new railway. Parliament has also received the ES, which describes the Phase One scheme and the proposals to avoid, reduce or remedy the likely significant environmental effects it identifies. Its purpose is to ensure that Parliament considers these effects of Phase One before determining whether it should receive development consent.

What does the ES contain?

The ES is composed of a large number of documents. All of it is publicly available. If you want to know about the effects of Phase One on the environment, or live in an area near the route, the following descriptions should help you to identify the documents that are most relevant to you.

The non-technical summary (NTS)

This is a summary of the Phase One project and its likely significant residual effects on the environment. You may find this a useful place to start.

Volume 1: An introduction to the ES and the project

This is an overview of the Bill and the environmental impact assessment (EIA) process, which explains:

- the approach to consultation;
- aspects of the project, construction techniques and operational assumptions; and
- the main alternatives considered by the Government to both the HS2 network and the Phase One project.



Visualisation of a viaduct in the Colne Valley

Volume 2: Community Forum Area (CFA) reports

The proposed route is split into 26 sections. Volume 2 consists of 26 reports (one for each section) and their associated map books. These comprehensively describe the project at a local level. The reports explain the design and other measures included in the project to avoid, reduce or manage any adverse environmental effects.

If you live near the proposed route and want to know more about how HS2 may affect your area, please consider reading your local CFA report. The areas covered by each CFA report are shown on the next page.

Volume 3: Route-wide effects

This sets out the likely significant environmental effects that were considered on a wider scale. For example, the report assesses the project's effect on the Chilterns Area of Outstanding Natural Beauty (AONB).

Volume 4: Off-route effects

Volume 4 examines any likely significant environmental effects at locations beyond the Phase One route corridor and its local environment.

Volume 5: Appendices and map books

Volume 5 contains supporting environmental surveys, information and maps, including the draft Code of Construction Practice – the principles that will guide HS2 Ltd and its contractors in being a good neighbour to local residents, businesses and community facilities.

STRUCTURE OF THE ENVIRONMENTAL STATEMENT

Non-technical summary (NTS)

This is a summary of the Phase One project and its likely significant residual effects on the environment. You may find this a useful place to start.

Volume 1: An introduction to the ES

Volume 1 is an overview of the Bill and the environmental impact assessment (EIA) process.

Volume 3: Route-wide effects

Volume 3 sets out the likely significant environmental effects that were considered on a wider scale.

Volume 4: Off-route effects

Volume 4 examines any likely significant environmental effects at locations beyond the Phase One route corridor and its local environment.

Volume 2: Community Forum Area reports

Volume 2 consists of 26 reports and their associated map books. Details of each Community Forum Area (CFA) are below.

CFA1 Map EUSTON STATION & APPROACH CFA1 Report	CFA2 Map CAMDEN TOWN AND HS1 LINK CFA2 Report	CFA3 Map PRIMROSE HILL TO KILBURN (CAMDEN) CFA3 Report	CFA4 Map KILBURN (BRENT) TO OLD OAK COMMON CFA4 Report	CFA5 Map NORTHOLT CORRIDOR CFA5 Report	CFA6 Map SOUTH RUISLIP TO ICKENHAM CFA6 Report	CFA7 Map COLNE VALLEY CFA7 Report	CFA8 Map THE CHALFONTS AND AMERSHAM CFA8 Report	CFA9 Map CENTRAL CHILTERNES CFA9 Report	CFA10 Map DUNSMORE, WENDOVER AND HALTON CFA10 Report	CFA11 Map STOKE MANDEVILLE AND AYLESBURY CFA11 Report	CFA12 Map WADDESDON AND QUANTON CFA12 Report	CFA13 Map CALVERT, STEEPLE CLAYDON, TWYFORD & CHETWODE CFA13 Report
CFA14 Map NEWTON PURCELL TO BRACKLEY CFA14 Report	CFA15 Map GREATWORTH TO LOWER BODDINGTON CFA15 Report	CFA16 Map LADBROKE AND SOUTHAM CFA16 Report	CFA17 Map OFFCHURCH AND CUBBINGTON CFA17 Report	CFA18 Map STONELEIGH, KENILWORTH AND BURTON GREEN CFA18 Report	CFA19 Map COLESHILL JUNCTION CFA19 Report	CFA20 Map CURDWORTH TO MIDDLETON CFA20 Report	CFA21 Map DRAYTON BASSETT, HINTS AND WEEFORD CFA21 Report	CFA22 Map WHITTINGTON TO HANDSACRE CFA22 Report	CFA23 Map BALSALL COMMON AND HAMPTON-IN-ARDEN CFA23 Report	CFA24 Map BIRMINGHAM INTERCHANGE AND CHELMSLEY WOOD CFA24 Report	CFA25 Map CASTLE BROMWICH AND BROMFORD CFA25 Report	CFA26 Map WASHWOOD HEATH TO CURZON STREET CFA26 Report

Volume 5: Appendices and map books

The majority of the appendices in Volume 5 examine certain topics in detail, either within a CFA or more widely. Appendices assessing a particular topic area are identified by the reference codes below. Volume 5 also contains supporting documents, such as the draft Code of Construction Practice.

AGRICULTURE, FORESTRY AND SOILS AG	AIR QUALITY AQ	COMMUNITY CM	CULTURAL HERITAGE CH	ECOLOGY EC	ELECTROMAGNETIC INTERFERENCE EM	LAND QUALITY LQ	LANDSCAPE AND VISUAL ASSESSMENT LV	SOCIO-ECONOMICS SE	SOUND, NOISE AND VIBRATION SV	TRAFFIC AND TRANSPORT TR	WASTE AND MATERIAL RESOURCES WM	WATER RESOURCES AND FLOOD RISK ASSESSMENT WR
--	--------------------------	------------------------	--------------------------------	----------------------	---	---------------------------	--	------------------------------	---	------------------------------------	---	--

Which issues are covered?

The CFA reports consider some or all of the topics below – as many as are relevant to the area. The appendices in Volume 5 examine them in greater detail, either within a CFA or more widely.

- Agriculture, forestry and soils (*these appendices are identified by reference codes starting 'AG'*)
- Air quality (AQ)
- Community (CM)
- Cultural heritage (CH)
- Ecology (EC)
- Electromagnetic compatibility (EM)
- Land quality (LQ)
- Landscape and visual assessment (LV)
- Socio-economics (SE)
- Sound, noise and vibration (SV)
- Traffic and transport (TR)
- Waste and material resources (WM)
- Water resources and flood risk assessment (WR)

How do I find what I'm looking for?

The non-technical summary is the best starting point. It introduces Phase One in general and covers each CFA in a few pages.

CFA reports present a detailed assessment of HS2 in a given area. They are between 150 and 300 pages long.

Technical appendices in Volume 5 provide in-depth data on a specific topic (see "Which issues are covered?", above). Each appendix has a reference code; the first two letters indicate the topic. For example, information on air quality (AQ) in Ladbroke and Southam (CFA 16) is found in Data appendix AQ-001-016.

Where is the ES available?

You can access the ES in three ways:

Digital – Libraries, local authority offices and parish councils along the proposed route have been supplied with the full ES in digital format, and will make this available to the public. To find your nearest location, visit the HS2 website, www.hs2.org.uk.

Print – Some libraries have also requested printed copies of the documents most relevant to their area.

Online – The full ES is accessible through the HS2 website, which also hosts supporting documentation and materials, and on www.gov.uk/dft.

What happens next?

Members of the public and other interested parties can send comments on the ES to the Secretary of State for Transport, who will publish them. Details of the ES consultation process are available through the HS2 website. Parliamentary rules allow at least 56 days for comments - the consultation closes on 27th February 2014.

Parliament will appoint an independent assessor to summarise the issues raised in consultation responses. This report will be made available to Members of Parliament before the Second Reading of the Bill – the first time that MPs will debate its main points.

Where to get further information

Further information about the Environmental Statement can be found on the HS2 Ltd website at www.hs2.org.uk and at www.gov.uk/dft. You can also contact the HS2 Public Enquiries Team on **020 7944 4908** or at hs2enquiries@hs2.org.uk.

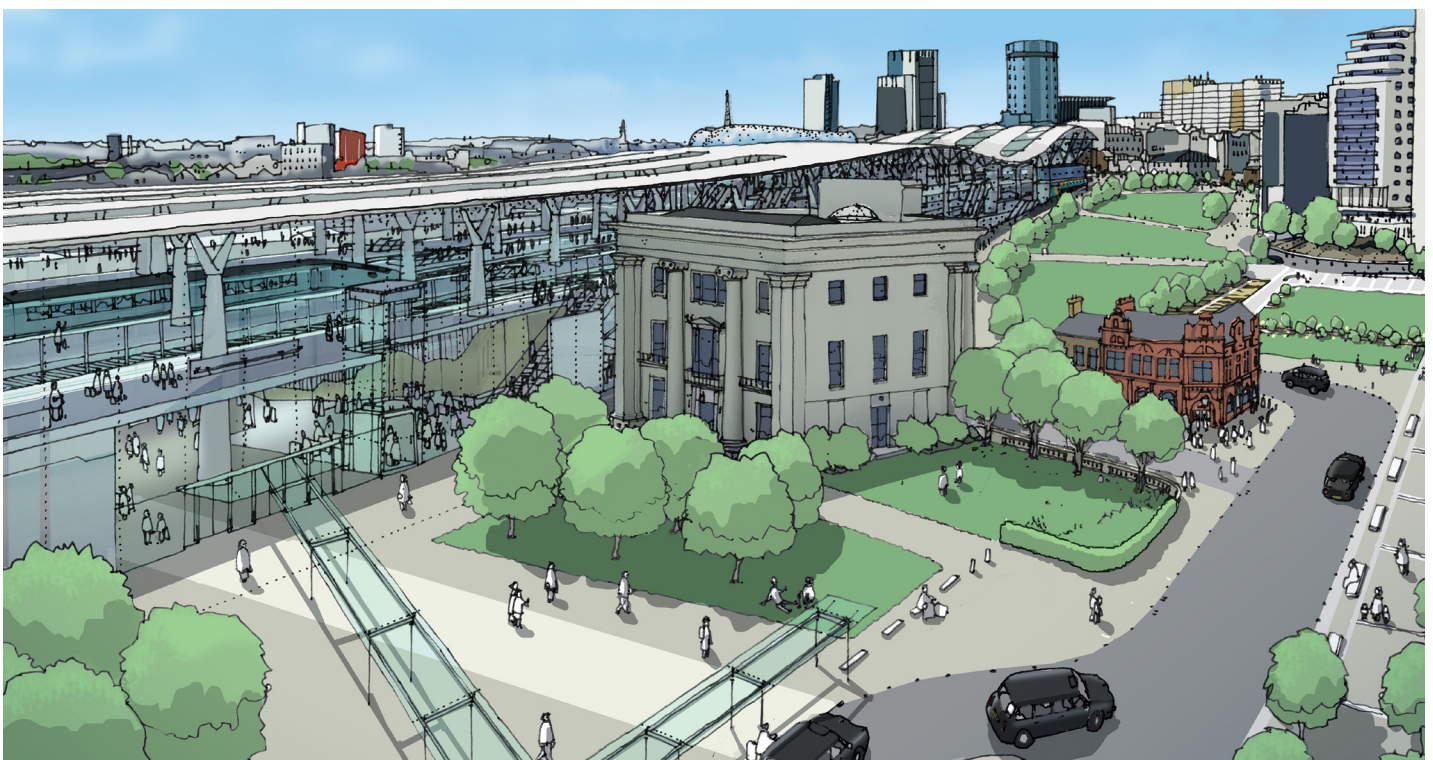

Artist's impression of Birmingham Curzon Street station