

[Redacted]

Re: GFL 16313

Dear [Redacted]

I refer to your application for a General Felling Licence and I am pleased to enclose same. You are obliged to adhere to the following instructions:-

- a) The licensee shall ensure that all felling and planting operations are carried out in accordance with Forestry and Water Quality, Forest Biodiversity, Forest Harvesting and the Environment, Forestry and Archaeology, Forestry and the Landscape and Forestry and Aerial Fertilisation guidelines and the Code of Best Forest Practice – Ireland and the Irish national Forest Standard published by the Department.
- b) The licensee shall treat all conifer stumps in conifer woodlands immediately following felling with a solution of urea to help prevent infection by butt rot (*Heterobasidion annosum*). Urea application will not be required where conifer/ broadleaved mixtures are being managed with the purpose of creating a broadleaved canopy in excess of 85%. The correct solution mixing rate is 1kg of fertiliser grade urea, 5 litres of water and one bottle of dye. Urea should not be applied to stumps within the buffer zones required by the Forestry and Water Quality Guidelines and Freshwater Pearl Mussel Requirements.
- c) Stagger felling over the 5 years of the licence.

You are instructed to adhere to the conditions of Emmet Byrnes, Forest Service Archaeologist, as listed in his report dated 6th August 2014 (copy attached).

You are also instructed to adhere to the conditions of Orla Fahy, Forest Service Ecologist, as outlined in her report dated 26th September, 2014 (copy attached).

Please see attached communication from Tipperary County Council dated 12th August, 2014. Any specific requirement outlined in the letter is a matter to be addressed directly with the County Council concerned.

All aerial fertilization of restocking sites requires the prior written approval of this Department.

An inspection of the plantation will be arranged at a later date, to check on the utilisation of the licence.

Yours sincerely,

Maureen Maguire
Maureen Maguire
Felling Section
Forest Service
Tel: 053 911 6513

Date 9/10/2014

AN ROINN TALMHAÍOCHTA, BIA AGUS MARADEPARTMENT OF AGRICULTURE, FOOD AND THE MARINEFORESTRY ACT, 1946 - SECTION 49GENERAL FELLING LICENCE

Pursuant to the powers vested in him by section 49 of the Forestry Act, 1946, the Minister for Agriculture, Food and the Marine hereby grants to the person (hereinafter referred to as the Licensee) specified in the First Schedule hereto a licence authorising:-

In accordance with paragraph (a) of sub-section (1) of the said section, the uprooting or cutting down of trees in the wood specified in the Second Schedule hereto on land owned by the Licensee, in the ordinary course of thinning, in accordance with the general practice of good forestry, that wood.

The authority conferred by this licence will be exercisable for a period of five (5) years from this date, unless it is sooner terminated by the Minister.

The following condition(s) are attached to this licence

- a) Operations as per Harvest Plan attached

FIRST SCHEDULE REFERRED TO IN FOREGOING LICENCEParticulars as to the Licensee

<u>Name of Licensee</u>	<u>Address</u>
[REDACTED]	[REDACTED]

SECOND SCHEDULE REFERRED TO IN FOREGOING LICENCEParticulars as to the wood in which trees may be uprooted or cut down in the ordinary course of thinning that wood

<u>County</u>	<u>Townland(s) where situated</u>	<u>Name and Location of Wood</u>
Tipperary	Kilcooly Abbey	Areas outlined in red on the attached maps.

Signed on behalf of the Minister for Agriculture, Food and the Marine



Date 03 OCTOBER 2014



1 Certified Spectra Map

Applicant:	OS Sheet:	Contract No.:	PLS					
█								
█								
█								
Client:	Plot No.	Area (ha)	CHP	Supp.	Blockage	Thinning Type	Estimate of DPC	Est. No.
	1	25.06	CHP	NS	2450	1st Thin	1970	
	2	8.11	CHP	NS	2450	1st Thin	1990	
	3	3.5	CHP	NS	2450	1st Thin	1990	
	4	5.72	CHP	NS	1600	1st Thin	1990	
	5	1.12	CHP	NS	1600	Sub-thin	1985	
	6	1.77	CHP	NS	2150	1st Thin	1970	
	7	1.95	CHP	NS	2700	1st Thin	1970	
	8	4.59	CHP	BT	2500	1st Thin	1970	
	9	2.53	CHP	NS/SS	1600	Sub-thin	1987	
	10	4.13	CHP	NS	2450	1st Thin	1990	
	11	7.65	CHP	NS	2200	1st Thin	1980	
	12	23.82	CHP	NS	1800	Sub-thin	1987	
	13	1.26	CHP	NS	1600	1st Thin	1987	
	14	4.06	SHF	SP/SL	1600	Sub-thin	1987	
	15	125.15						

Removal Scale 1:500

All plots labelled and outlined are prepared away for final sub-plot demarcation

Plot No.	1	2	3	4	5	6	7	8	9	10	11	12	13	14	15	16
Specimen Certified By																
Name Contract No.																

Scale 1: 10560.0

Contract: Test

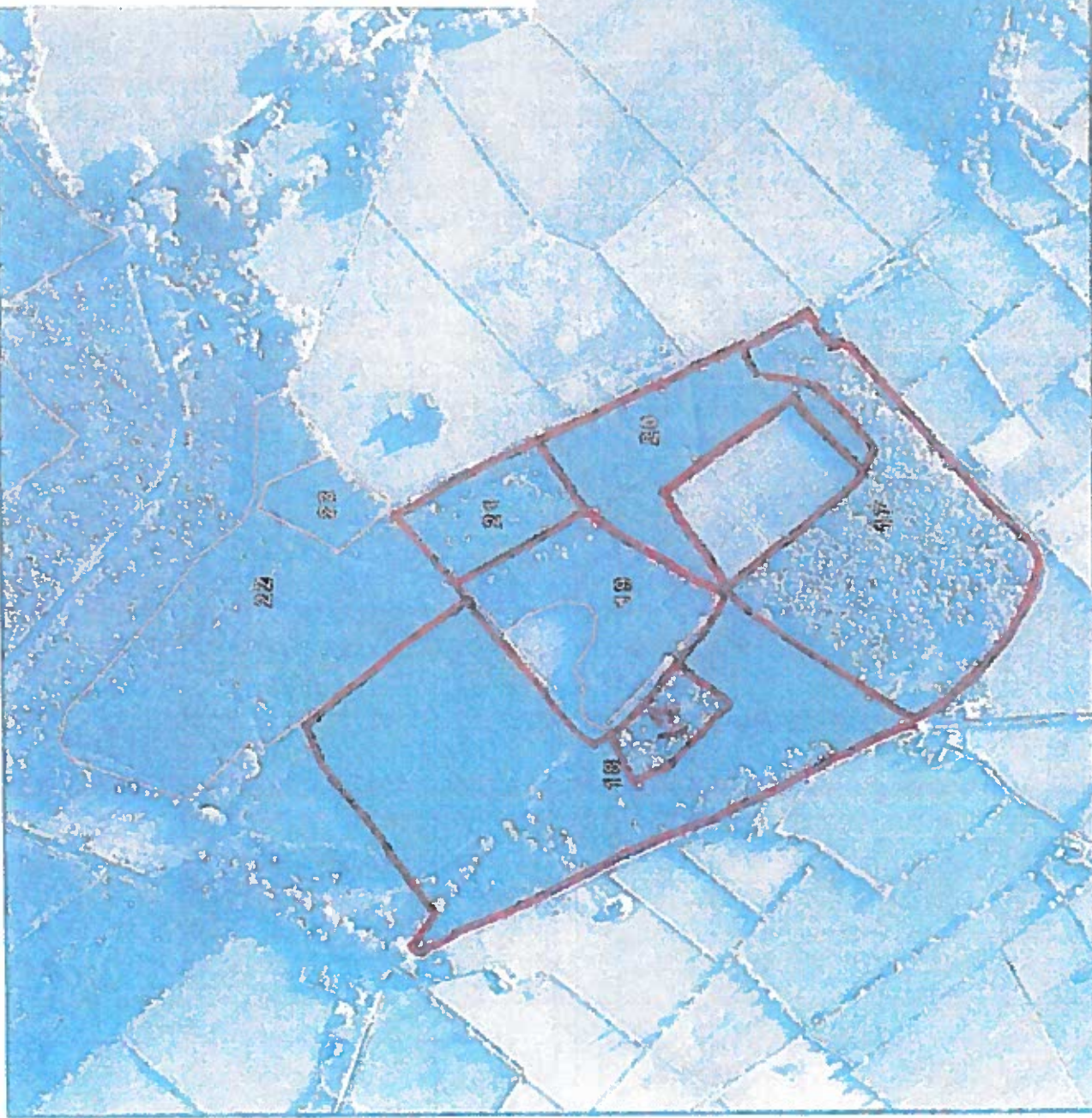

Certified Species Map

Applicant: [REDACTED]		Ave Sheet:		Page:	
County: [REDACTED]		Contract No:		Date:	
Townland: [REDACTED]		P/Yr:		Date:	
Plot No	Area (ha)	LT	Spp.	Stocking	Mts. Type
17	10.06	MBE	Oak/ash	0.00	F
18	10.17	CHH	BS	0.00	F
20	4.52	CHH	BS	0.00	F
21	2.4	CHH	BS	0.00	F
22	33.75				
Total: 33.75					
Remarks: Scale 1:5000					
Area surveyed by		Date		Date	
Name / Contact No		[REDACTED]		2005/2014	
Species Certified by		Date		Date	
Name / Contact No		[REDACTED]		2005/2011	

Ordnance Survey Ireland Licence No. EN 0076413. Copyright Ordnance Survey Ireland/Government of Ireland
 Unauthorized reproduction is not permitted. This map is for Forest Service related use only.

Scale 1: 8000.0
 Contract: Test

Forest Service,
Department of Agriculture, Food and the Marine,
Agriculture House,
Kildare Street,
Dublin 2.

6th August 2014

Felling Section,
Forest Service,
Department of Agriculture, Food and the Marine,
Johnstown Castle Estate,
Co. Wexford.

Re: GFL 16313 – Kilcooly Abbey, Co. Tipperary

Dear Sir / Madam,

I recommend that the conditions outlined below should also be attached to this felling licence

Yours sincerely,

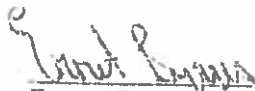

Emmet Byrnes
Forestry Inspector (Grade 1)
(Acting Senior Archaeologist)

GFL 16315

Kilcooly Abbey, Co. Tipperary

Archaeological conditions

A number of the areas proposed for felling (thinning) - i.e. Plots 8, 18, 20, 21, and 23 - are immediately contiguous to and may contain portions of Recorded Monuments. These are a large bi-vallate ringfort (TS 043-029), a mound (TS 043-033), and the boundary ditch of the post-medieval deer park (TS 043-034_017). In addition Plot 7 is adjacent to an enclosure (TS 043-023) and Plot 8 is adjacent to a boat house which has fragments from a medieval doorway (TS 043_034-027) incorporated into its fabric.

The Cistercian abbey at Kilcooly Abbey (TS 043-034_001) is also a National Monument in State Ownership (Reg. No. 218).

It is of concern that every effort should be made to prevent damage to this complex of Recorded Monuments and that there would be an appropriate response should any previously unrecorded archaeology be discovered during the course of the works.

Consequently, the following conditions should be adhered to during the proposed works:

1. As always, at all times during the proposed operations the terms of the 'Forestry and Archaeology Guidelines' and 'Forest Harvesting and the Environment Guidelines' should be adhered to.
2. Specifically, the areas demarcated in yellow with red hatching around the large bi-vallate ringfort (TS 043-029), the mound (TS 043-033), and the boundary ditch of the post-medieval deer park (TS 043-034_017) should be excluded from the proposed works.
3. That means a minimum exclusion zone of 20m from the outermost extent of each monument, as illustrated.
4. Any trees proposed for thinning in these excluded areas should only be felled following a thorough field inspection by a suitably qualified archaeologist retained by the applicant/consultant forester and the preparation with the forester of a plan outlining the most appropriate means to fell and remove trees from in and around the monuments for the consideration of the Forest Service, DAFM, and National Monuments Service, DAHG..
5. During the course of works elsewhere these exclusion zones should be appropriately fenced or marked off and all operational staff should be apprised of the location of the exclusion zones and the monument within each.
6. Machinery should not be allowed to enter the zones and trees should be felled away from the zones with the logs should be piled and presented in a way that avoids any entry by the harvester or forwarder into the exclusion zones.
7. Any unrecorded archaeological site or artefact discovered during the course of the proposed felling and replanting operations must be left undisturbed and the relevant authorities notified immediately. A minimum exclusion zone of 20m, preferably 100m or more, must be created until the site had been investigated.
8. Furthermore, the yellow/red demarcated areas around the enclosure (TS 043-023) and the boat house with architectural fragments (TS 043-034_027) should also be treated as operational exclusion zones and generally avoided during the works, access and egress etc.
9. Otherwise, no known archaeological objections.

Ernest Byrnes
Ernest Byrnes
Forest Service Inspectorate
Department of Agriculture, Food and the Marine,
Ph: 01 6072220
Mobile: 087-2213587

501 6013 - IMMINENT AREAS

TS OHS-024
"BI-WASTE RINGFORD"

EXCISE THIS AREA!



TS OHS-024.027
"ARCHITECTURAL FRAGMENT"

BOAT HOUSE

AVOID !!

013-033 - Training Areas

013-033
"BOUND"

EXCLUDE THIS AREA!

013-034 LOT

"DEER PARK - BOUNDARY"

EXCLUDE THESE AREAS!

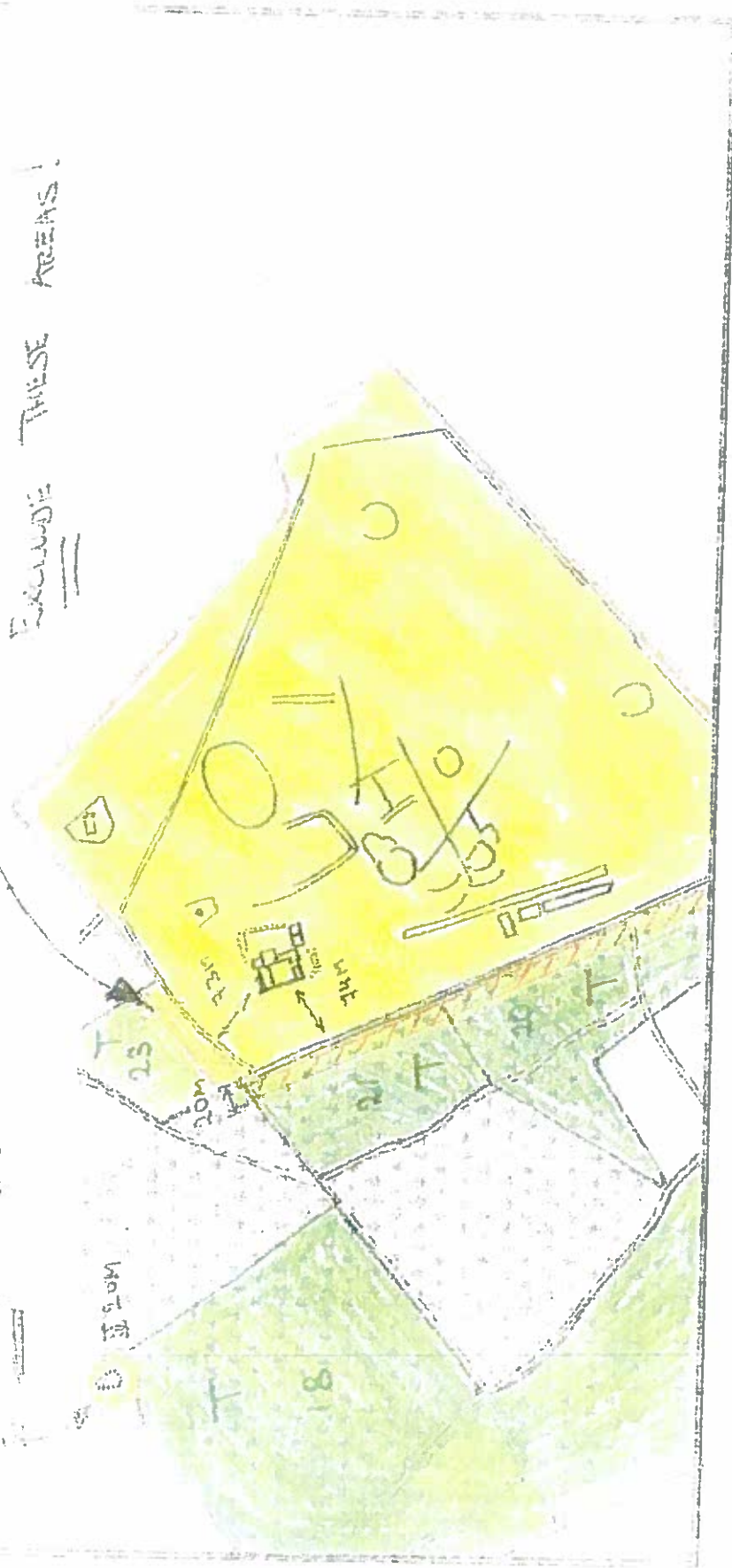

20th Nov 13 - THINNING AREAS

To 0108-023
"E MESS SIDE"

Avoid!

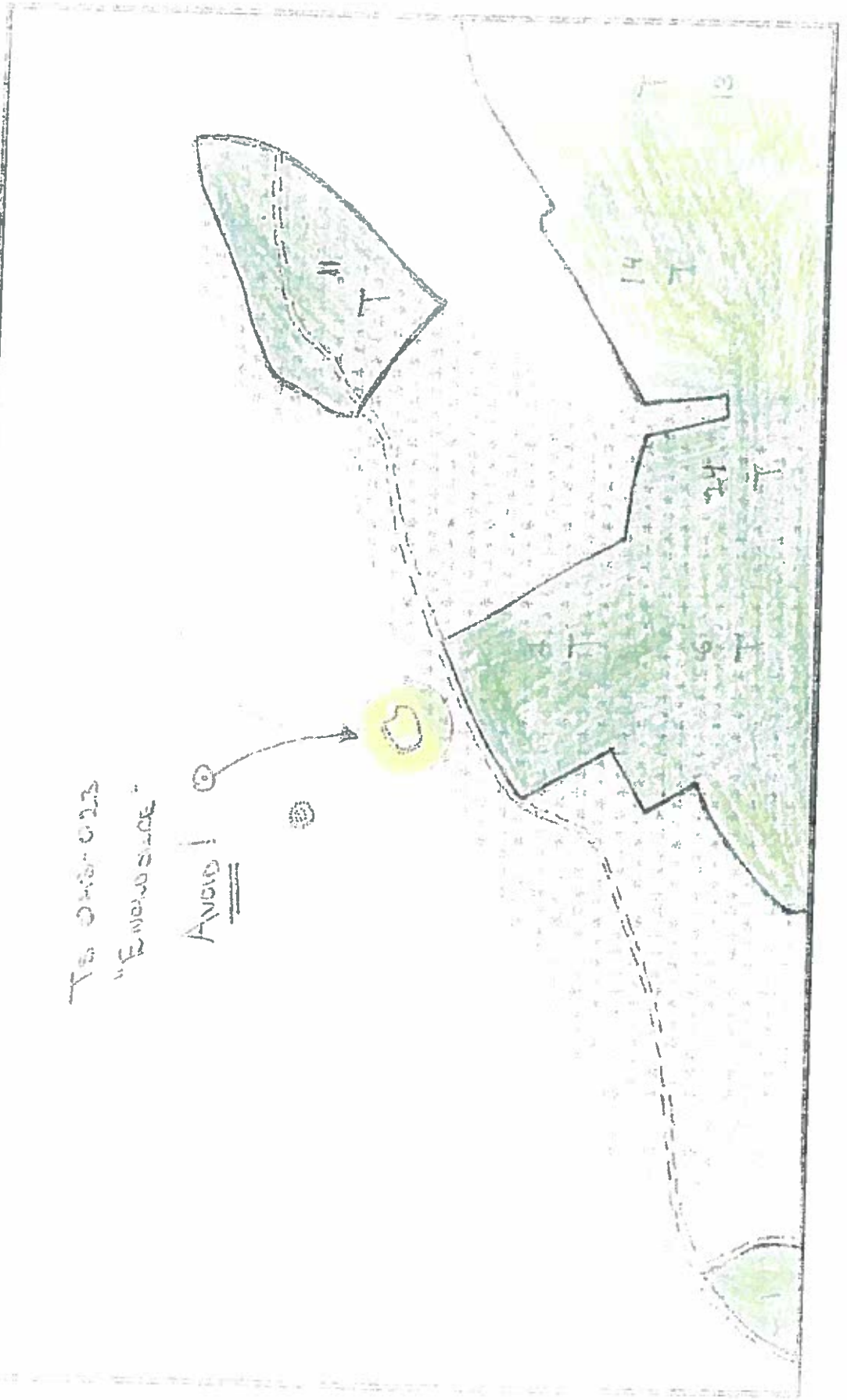

Forest Service
Dept. of Agriculture, Food & the Marine
Davitt House
Castlebar
Co. Mayo
26/09/2014

Maureen Maguire
Felling Section
Forest Service
Department of Agriculture, Food and the Marine
Johnstown Castle Estate
Co. Wexford.

RE: GFL16313 and GFL16314, Kilcooly Abbey, Co. Tipperary.

Maureen,

GFL16313 is a thinning application for 158.9ha of conifers and broadleaves and GFL16314 is a clearfell application for 29.41ha of conifers at Kilcooly Abbey, Co. Tipperary. The site contains numerous aquatic zones and a small lake which is a proposed Natural Heritage Area (Kilcooly Abbey Lake pNHA, site code 000958). Two of the plots (Plots 9 and 10) proposed for clearfelling and four of the plots (Plots 3, 4, 5 and 8) proposed for thinning are in close proximity to the pNHA. National Parks and Wildlife Service had no observations regarding either the clearfelling or the thinning.

*The site synopsis for Kilcooly Abbey pNHA (000958) states it is 'a small lake in the estate grounds of an old abbey in Co. Tipperary, which supports a varied aquatic flora including species of bladderwort (*Utricularia spp.*), stonewort (*Chara spp.*) and Bulrush (*Typha latifolia*). The latter forms a marginal band around the open water. The presence of Lesser Bulrush (*Typha angustifolia*) is noteworthy, as it is quite rare in Ireland, especially in the southern half of the country. Otters use this site. Breeding birdlife on the lake include Mallard, Moorhen, Coot and a colony of Herons. Some eutrophication of the open water has occurred due to nutrient run off from nearby lands. This could pose a threat to the current ecological balance of the aquatic habitat'.*

Combined GFL16313 and GFL16314 comprise an area of 188.31ha but if GFL16307 (windblown clearfell) is included the total operational area is 197.18ha (38.28ha of which is clearfelling). Given the size and scale of the proposed operations there is the potential to impact on the aquatic zones, the pNHA and species that occur on the site. The site synopsis for the pNHA states that otters occur on the site. Otters are an Annex IV species under the Habitats Directive [92/43/EEC] and as such are protected wherever they occur and the deliberate disturbance of otters and the destruction of their resting and breeding places is an offence. In addition, the pNHA description refers to a colony of herons and this must be protected during all operations. All birds are protected under the EU Birds Directive [2009/147/EC] and the Wildlife Act, 1976 (including amendments made in SI 283/1980 and

SI 397/1985). The National Biodiversity Data Centre also shows the presence of red squirrel (*Sciurus vulgaris*) in the 2km squares within which the application occurs. If there are red squirrels in the area, Section 23 of the 1976 Wildlife Act, as amended, applies

The information submitted with the application makes no reference to the aquatic zones on site and the presence or absence of effective buffer zones. It appears from the aerial photos that there are broadleaf trees around the lake but it is not possible to determine whether or not there is an effective buffer. An effective buffer is a buffer zone and/or one or more sequential buffer strips, which, by virtue of their topography, impeded drainage and/or density of vegetation cover, have sufficient water retention capacity to filter and retain suspended solids and nutrients in drainage water, so that total suspended solids and nutrient concentrations entering the aquatic zone are minimised. It should also be noted that the application is in the Nore Freshwater Pearl Mussel catchment but not within a 6km zone. All existing aquatic buffer zones must be protected during operations. In the areas to be thinned if aquatic buffer zones are not present or do not meet the recommended width, consideration should be given to the creation of aquatic buffer zones or to thinning heavier than normal in the aquatic buffer zone to encourage ground vegetation establishment and to create more favourable conditions for future felling.

As mentioned above, the size and scale of the proposed works is of concern and strict adherence to all Forest Service Guidelines, licence conditions and best forest practice is essential to ensure that no adverse impacts occur during the proposed works.

I recommend that the conditions outlined below are attached to GPL16313, Killeooly Abbey, Co. Tipperary:

- At all times during the proposed operations the terms of the Forestry and Water Quality Guidelines, Forest Biodiversity Guidelines and the Forestry Harvesting and the Environment Guidelines must be adhered to.
- At all times during the proposed operations the terms of the Forestry and Otter Guidelines are adhered to.
- The colony of herons must be protected during all proposed operations. The location of the colony of herons must be identified, marked on all relevant maps and if required marked on the ground. In addition, the species must not be disturbed during the breeding season.
- All operational staff must be apprised of the location of the aquatic zones, the heron colony, any otter holt or couch sites and the associated buffer zones.

In addition, the applicant should be advised that, where possible, in areas where there is no aquatic buffer zone or if does not meet the recommended width, an aquatic buffer zone should be created or the area thinned heavier than normal to encourage ground vegetation establishment.

I recommend that the conditions outlined below are attached to GPL16314, Killeooly Abbey, Co. Tipperary:

- At all times during the proposed operations the terms of the Forestry and Water Quality Guidelines, Forest Biodiversity Guidelines and the Forestry Harvesting and the Environment Guidelines must be adhered to.
- At all times during the proposed operations the terms of the Forestry and Otter Guidelines are adhered to
- The colony of herons must be protected during all proposed operations. The location of the colony of herons must be identified, marked on all relevant maps and if

required marked on the ground. In addition, the species must not be disturbed during the breeding season.

- All operational staff must be apprised of the location of the aquatic zones, the heron colony, any other holt or couch sites and the associated buffer zones.
- At restock create aquatic buffer zone with a minimum width of 10m on each side of the aquatic zone.

Yours sincerely

Dr. Orla Fahy
Regional Inspector and Ecologist



Imelda McCarthy,
Felling Section,
Forrest Service,
Department of Agriculture, Food & Marine,
Johnstown Castle Estate,
Co. Wexford.

12th August 2014

Forestry Service Ref	GFL 16314
Applicant	[REDACTED]
Re	GFL at Kilcooley Abbey, Co. Tipperary

* Clara,

Having reviewed the above comments and the documentation submitted on the 20th June 2014, I wish to advise you that:

There are no Protected/Listed Trees within the areas indicated on the maps submitted, these lands are not located within any designated amenity area.

The appropriate considerations must be made as the indicated site is within 15km of:

- The River Barrow and River Nore SAC
- Galmoy Fen SAC
- Cullahill Mountain SAC
- SPahill and Clonmantagh Hill SAC
- The Loughan SAC

The site is within 13km of the following SPA

River Nore SPA

Any works to the entrance may require permission and to contact Tipperary County Council prior to carrying out modifications, construction, maintenance or improvement to the entrance at the public road. All works must be carried out in accordance with the 'The code of Best Forest Practice – Ireland' and the current suite of environmental guidelines as published by the Forest Section.

Prior to the commencement works, please request the applicant to contact the County Council's Area Engineer with the following details, i.e. commencement date, a map indicating the possible haulage routes and possible access points off the public roads and the appropriate traffic management measures will be taken to catered for movement of the large vehicles in the area. The applicant shall ensure that material from the site is not spread or deposited on the public roadway and is liable to make good any damage caused to the public road.

Is mise le Meas.

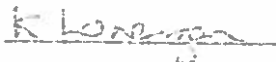

For Director of Services

Harvest Site Plan

Property: Kilcooley Abbey

Sales Reference: Kilcooley

Harvest Type: First and Subsequent Thinning

Felling Plan

Rack Only Rack & Selection Selection only
Rack & Chevron Full Face

Environmental Assessment:

Archaeology: Ground Conditions: Landscape: SAC/NHA/SPA:
 Amenity/Recreation: Water Quality: Habitats/Biodiversity

If any of above is relevant then please specify:

All guidelines set out by Archaeologist Emmet Byrnes in relation to this site will be strictly adhered to with regard to preserving and excluding areas of historic and archaeological importance. Ground conditions within the harvest area will be monitored and brush mats will be used to protect the underlying soil. Areas proposed for harvesting will have warning signs erected nearby and the general public will be made aware of harvesting activities in the area, via information signs at the entrance. All health and safety documents will be in order prior to commencement of the works.

Drains must be free from debris before machine leaves sites!!

Other Considerations:

Roads: Utility Lines: People/Property:

If any of above is relevant then please specify:

No harvester/Forwarder traffic is allowed on forest road at any time. Machine driver should not cross underneath ESB unless Forester is notified in advance. Please be mindful of people and property.

Mitigation measures

After Liasing with Emmet Byrnes and Orla Fahy, we acknowledge specific areas of importance in relation to Ecology and Archeology and aim to preserve and protect these on the ground at all times. We will mitigate possible encroachments on these areas by marking out areas of importance on the map and on the ground and informing contractor of same. With regard to siltation or possible contamination of any water source, if the site conditions become wet and running occurs, we will assess the operations and if we feel they may have a negative impact on the ecology of the area we will cease operations. Also brush mats and silt

traps may be used in order to curb possible siltation. Well planned harvest routes and alteration of extraction racks and headlands will minimise ground disturbance also.

Public safety is of utmost importance also on this high amenity property. The general public will be made aware of the harvesting operations in the area and will have the option to phone the free phone number provided if they need further clarification. Any proposed harvest areas will be off limits to walkers, runners, riders etc until operations have ceased. We will be upholding the concerns of the New Owner in relation to public access onto his lands also.

All operations will coincide with code of best forest practice and related guidelines from NPWS, Fisheries and Archaeology.

Harvesting:

Agreed output per week: 200 m³ Gang size Max: N/A Measurement method: Weigh/Bridge

Start Date:

Completion Date:

Harvest From All day

Days Monday to Friday Yes (incl.)

Harvesting Site Specifications

1. All staff must wear High visibility jacket and Hard hat at all time. Chainsaw contractors must wear all required PPE equipment during operations.
2. All trees along head lines that are damaged by extraction traffic must be removed and their stumps treated with UREA.
3. Increase thinning intensity and brush use near watercourse to open canopy and allow ground flora to prevent erosion and run-off at later thinning stages.

Thinning Control: Data attached yes No

Agreed equipment: Harvester head data must be relayed to Regional forest manager weekly

Removals: Start date: _____ Completion date: _____

Double handling required: Yes No

Removal from 12 am to 12 pm (incl.)

Days Monday Yes to Friday Yes (incl.)

Agreed Truck Types: Artic

Rigid Rigid and Trailer

Person responsible for timber security: _____

See Harvest Site Map for the designated transport route

I hereby agree to carry out the harvesting operation in accordance with the conditions as laid down in this plan.

Safety:

Having reviewed the Harvest Site plan, I hereby agree to implement this Plan in accordance with all relevant Health & Safety legislation and guidelines.

Safety Officer: _____

Signed: _____

EMERGENCY CONTACT NUMBER

Agencies	Telephone	Location
FEL Manager	086-0281053	Wexford
Garda Síochána	112	Kilkenny
Forest Service	0719141283	Nationwide
Fire station	112/911	Carlow/Kilkenny
ESB emergencies	1850-372-999	Nationwide
Hospital	112	Kilkenny general

Standard Conditions of the Harvest Site Plan

1) General

Site foreman shall keep Harvest Site Plan available on site while work is in progress and ensure all conditions are adhered to. Log Quality Assurance system to be adhered to for all direct Harvesting Operations.

2) Specification

- 2.1 Cut trees as close to ground as possible. Maximum stump height for thinnings is 10cm and 15cm for clearfells, on high side of stump. (Maximum stump height for windblown trees is 20cm.)
- 2.2 Carry out stump treatment immediately after felling trees
- 2.3 Avoid damage to standing trees. Surface extraction paths for forwarders with branches and tree tops. Avoid deep rutting especially in thinnings. Suspend operations where serious damage has started to occur.
- 2.4 Do not forward or skid timber on forest roads unless agreed under other considerations in the Harvest Site Plan. Do not stack timber at or near culverts or bridges - see distance specifications in Forest Service Fisheries Guidelines.
- 2.5 Fell and section to waste dead or unharvestable trees unless otherwise specified before sale.
- 2.6 Thin crop in compliance with Code of Practice on Thinning Control.
- 2.7 Process felled trees down to 7cm top diameter. Leave no harvestable billets in tops. Remove all harvested products.
- 2.8 Protect drains during extraction with effective use of billets - remove immediately extraction is completed. Keep roads, roadside drains, culverts and main forest drains free of slash and billets.
- 2.9 Harvest all products to Coillte / ITC specifications unless otherwise agreed with customer.

3) Safety

- 3.1 All persons engaged in Harvesting shall comply with current safety legislation.
- 3.2 All manual and machine operators working on the property must be trained and certified.

- 3.3 Take due care and give adequate notice to utility companies (Electricity, Telephone, Water companies etc.) as appropriate when felling trees adjacent to utility lines or railway tracks.
- 3.4 The contractor shall provide and erect sufficient warning signs on all approach roads to harvesting sites, during operations. All signage shall be to E.U Standard. Ref. S.1 132 of 1995.
- 3.5 Construct forest roadside stacks of timber in a safe and stable manner.
- 3.6 Take due care and notify Gardaí / County Councils when felling trees close to public roads, R.O.W.'s and buildings.
- 3.7 Leave all sites in a safe condition at the end of each working day.

4) Environment

- 4.1 Do not fell trees across boundary fences, ditches and walls.
- 4.2 Comply with Forest Service guidelines in relation to Forestry and Water Quality (July 2000), Forestry and Archaeology (July 2000), Forestry Biodiversity (July 2000) Forestry Harvesting and the Environment (July 2000) and Forestry and the Landscape (July 2000).
- 4.3 Avoid damage to amenity and recreational areas.
- 4.4 Keep site litter free, remove waste oil and filters from site and dispose of them safely.
- 4.5 Comply with "Code of Practice Safe use of Chemicals in Forest Operations"

5) Removals of Timber

- 5.1 Comply with the Code of Best Forest Practice - Ireland governing road transport and the removal of timber from forests.
 - 5.2 Keep barriers, gates locked as specified by the authoriser/ Manager. (Staff Circular 17/91)
 - 5.3 Comply with forest docket system.
 - 5.4 Comply with Department of Environment and Local Government road traffic regulations.
-

New Harvest

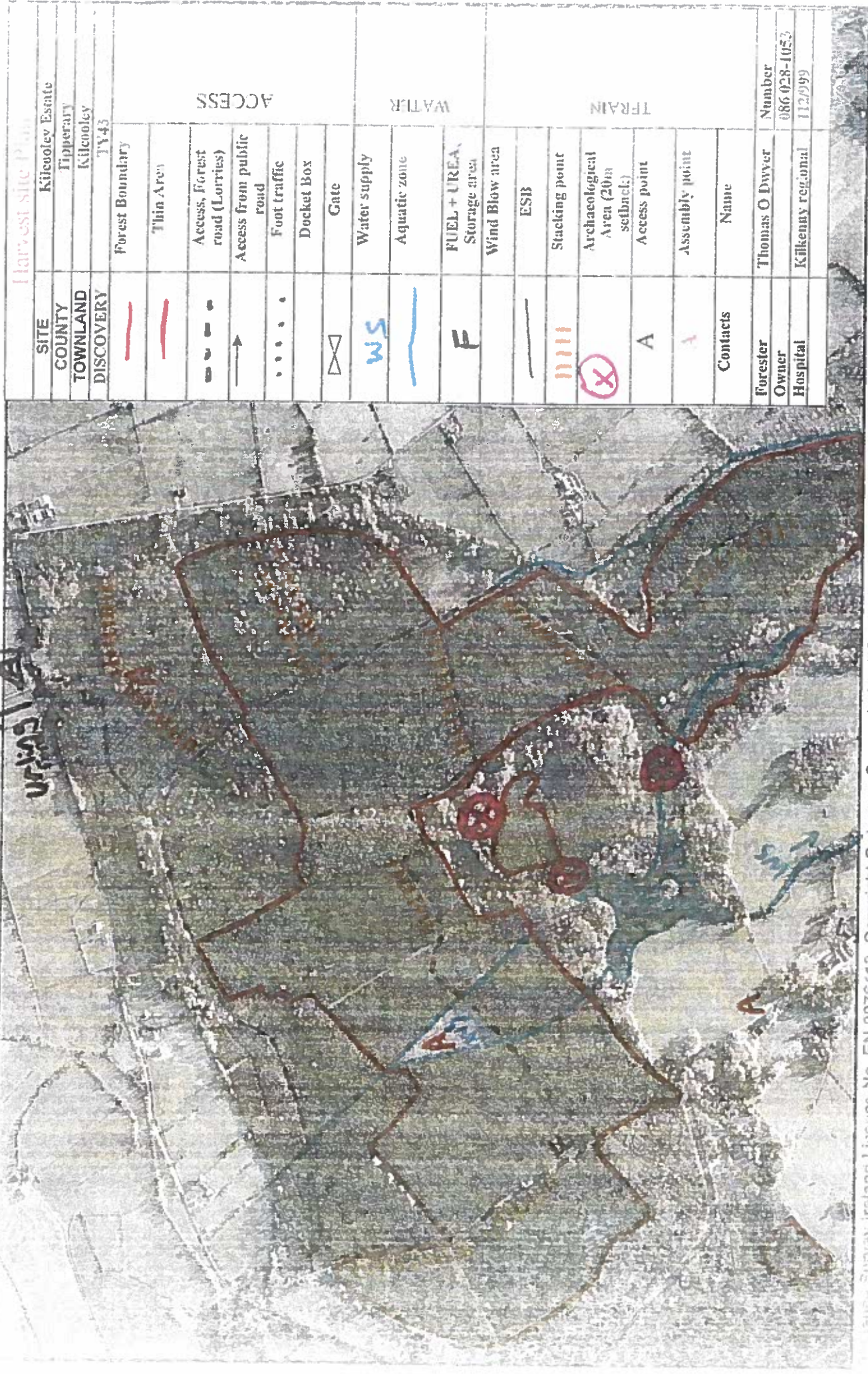

Harvest site Plan

SITE	Kilcooley Estate
COUNTY	Tipperary
TOWNLAND	Kilcooley
DISCOVERY	TY43
—	Forest Boundary
—	Thin Area
—	Access, Forest road (Lorries)
↑	Access from public road
•••••	Foot traffic
∞	Docket Box
∞	Gate
WS	Water supply
—	Aquatic zone
F	FUEL + UREA Storage area
—	Wind Blow area
—	ESB
	Stacking point
⊗	Archaeological Area (20m setback)
A	Access point
A	Assembly point
Contacts	Name
Forester	Thomas O Dwyer
Owner	Number
Hospital	086 028-1053
	112/099

Copyright Ordnance Survey Ireland/Government of Ireland
 This map is for Forest Service related use only.

Scale 1: 10560.0

Contract: Test



SITE	Kilnooley Estate
COUNTY	Tipperary
TOWNLAND	Kilnooley
DISCOVERY	TY33
Forest Boundary	ACCESS
Thin Area	WATER
Access, forest road (Lorries)	
Access from public road	
Foot traffic	
Docket Box	
Gate	
Water supply	
Aquatic zone	
FUEL + UREA Storage area	
Wind Blow area	
ESB	
Stacking point	
Archaeological Area (20m setback)	
Access point	
Assembly point	
Contacts	
Forester	Thomas O Dwyer
Owner	Number 080 028-1053
Hospital	Kilkenny regional 112/999

Ordnance Survey Ireland Licence No. EN 0076413. Copyright Ordnance Survey Ireland/Government of Ireland. No further reproduction is not permitted. This map is for Forest Service related use only.

Scale 1: 10560.0
 Contract: Test